

Urban Hotel *in Pesaro*

# CHARLIE



**116**  
Rooms



**Centre**  
Pesaro / seafront



**34,8 km**  
Rimini - F. Fellini airport



**59 km**  
Ancona - R. Sanzio airport



**155 km**  
Bologna - G. Marconi airport



**8 km**  
A14 Pesaro / Urbino exit



**2,7 km**  
Pesaro train station

## Main attractions

A. Pomodoro's Sfera Grande sculpture - 1,6 km  
Rossini House - 1,5 km  
Civic Museums - 1,6 Km  
Villa Caprile - 4,4 km  
Doge's Palace - 1,6 km

Viale Trieste, 281  
61121 Pesaro (PU)  
+39 0721 622090  
pesaro@charliehotels.it  
www.charliehotels.it

## HOTEL DESCRIPTION

Iconic hotel, now a completely renovated 4-star Urban Hotel to welcome you to the seafront of Pesaro and immerse you in the Viale Trieste nightlife, just a few metres from the sea and just a few steps from the port. A refuge of comfort and design, which opens its multiple and modular co-working and co-living spaces to all its guests and more. A hotel that opens also to the city and its vibrations, to become a stage and theatre of art, music, culture and territory.

## ROOM & SUITE

116 Rooms: 10 The Wind (20 sqm, with balcony), 25 Roosevelt Field (22 sqm), 20 Paris (22 sqm, with balcony): 20 doubles, 30 The Spirit (29 sqm, with balcony): 30 doubles. 9 New York (42 sqm, with balcony): quadruple. 10 The Flight (32 m<sup>2</sup>, with balcony): four-bed rooms. 12 The Atlantic (38 m<sup>2</sup>, with terrace, some with second balcony): quadruple.

## IN-ROOM FACILITIES

In The Wind rooms: French bed (140x200cm), 50-inch smart TV, minibar, safe, hairdryer, USB sockets, exposed wardrobe.

In the Roosevelt, Paris and The Spirit rooms: double bed (180x200cm) or two twins (90x200cm), 50-inch smart TV, desk, minibar, safe, hairdryer, usb sockets, exposed wardrobe.

In the New York, The Flight and The Atlantic rooms: double bed (180x200cm) or two twins (90x200cm) in the 2-person solution; in the 4-person solution, the double or twin bed is joined by a comfortable sofa that converts into a double bed; lounge area with sofa and desk, 50-inch smart TV, minibar, coffee maker, safe, hairdryer, USB sockets, exposed wardrobe, courtesy

set in the bathroom with bathrobe and slippers.

## HOTEL FACILITIES

Hall with lounge area and co-working spaces, restaurant and breakfast room, panoramic Lounge Bar 'Charlie's Bar', Room Service, gym, swimming pool, solarium, pool bar.

In each room there is a state-of-the-art automation system of the latest generation both from a technological and of sustainability. By means of sensors the system detects the presence of the guest and activates the automation mechanisms for controlling the air conditioning, lighting system and room comfort in general. In the absence of the guest the room is switched off, which allows energy consumption and its impact on the environment.

Maximum energy efficiency, emission savings and respect for the Planet.

## SWIMMING POOL & GYM

130 sqm located on the mezzanine floor of the building with sunbathing area, pool bar and separate children's pool.

## PARKING & GARAGE

Paid garage with 30 parking spaces.

## DOG FRIENDLY

Small dogs allowed (max. 10 kg) for a fee with PET package.



**Pesaro 2024**  
Capitale italiana  
della cultura



**unesco**  
Member of  
the Creative Cities Network

## MEETING SPACES

Mezzanine

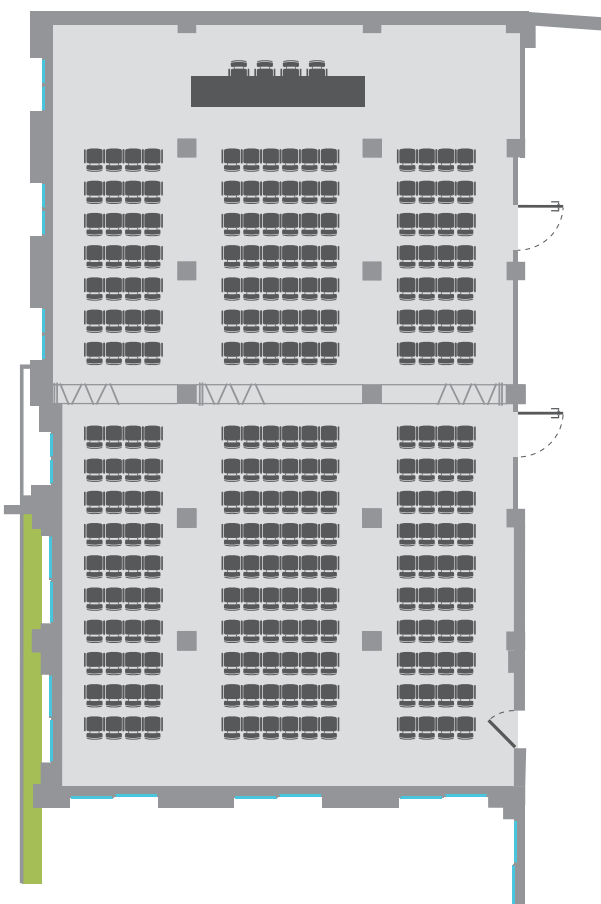

Sixth floor

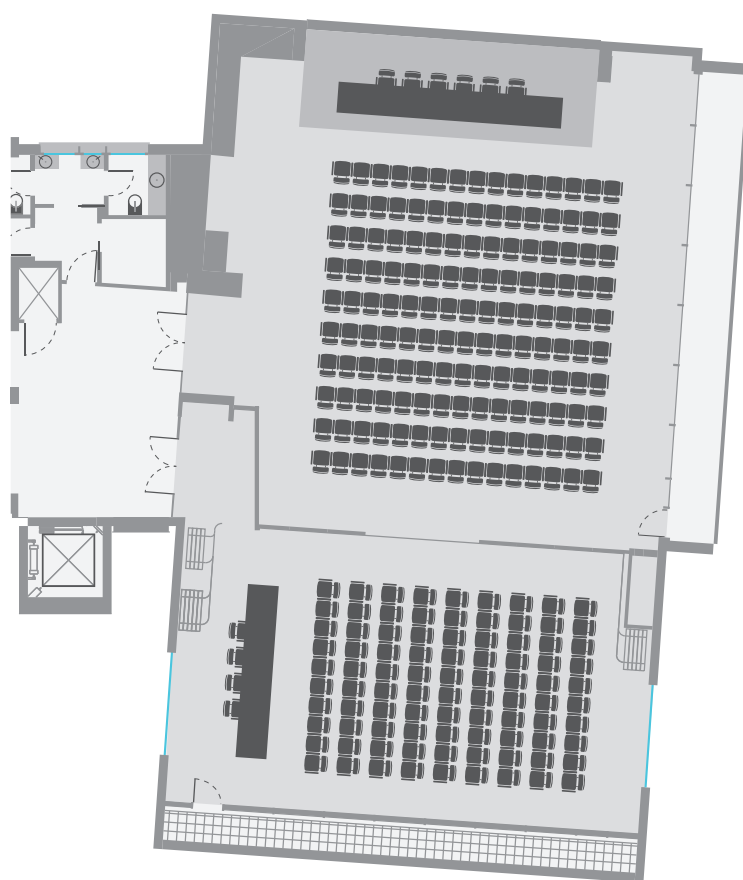

3 modular meeting areas, some of which overlook the sea. Equipped with video projector, fixed and mobile microphones, audio-video system and Wi-Fi connection.

On the ground floor there is a room of about 22 square metres, which is set up for co-working.

MEETING ROOM	THEATRE	BOARD	CABARET	CLASS	U SHAPE	CLOSED U SHAPE	L	W	M <sup>2</sup>	DAY LIGHT	SEA VIEW
<b>ALFA</b>	220	60	150	130	70	90	22	11	242	X	X
Bravo	130	40	75	85	50	60	14,2	11	156,2	X	X
Foxtrot	60	20	36	45	24	28	7,8	11	85,8	X	X
<b>ECHO</b>	80	40	90	32	28	32	21	12	252	X	X
Juliett	40	20	40	16	16	20	11	12	132	X	X
Kilo	30	20	40	16	16	20	10	12	120	X	
<b>SIERRA</b>	30	20	30	15	10	14	N/A	N/A	90	X	X
Terrazza Sierra	N/A	N/A	48	N/A	N/A	N/A	22	5	110	X	X